

User's Manual

The Stardust L2

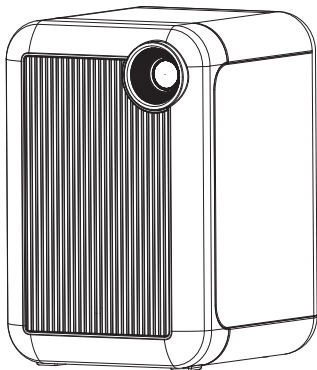

Components

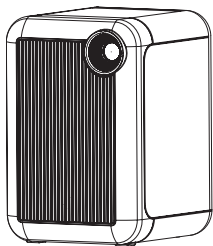

The Stardust L2

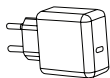

AC Adapter

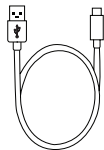

USB C-type Cable

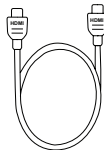

HDMI Cable

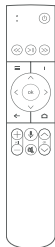

RCU

App Using Guide



You can download Various Apps from Google Play Store.

You can use pre-built Apps.

(e.g. YouTube, Disney+, pirme video, Red Bull TV, Music, ARD1, ORF TV THEK...)

You can use media player for playing media contents from external storage devices.

Name of each components

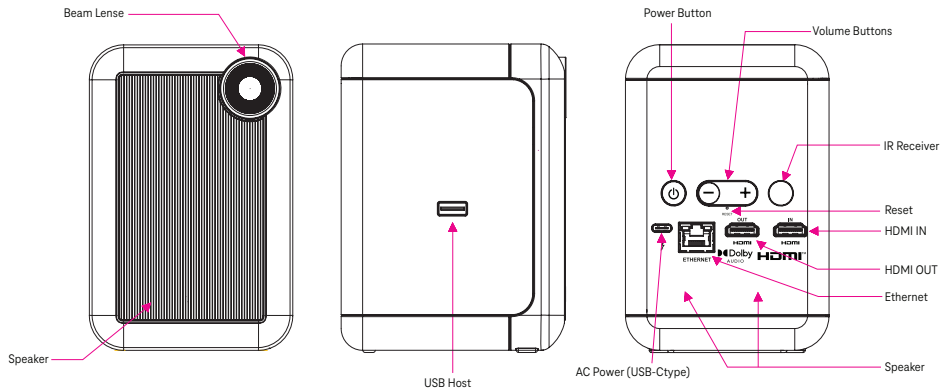

Key Button Features

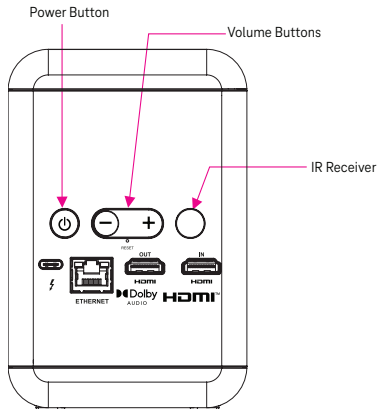

- Power ON

When you press Power Button longer than 3 seconds, projector is turned on with white LED On.

- Normal Power OFF

When you press Power Button longer than 3 seconds, projector is turned off with white LED Off.
(You can recover to Power ON with Power Button and Remocon Power Button.)

- Deep Power OFF

When you press Power Button longer than 6 seconds, Projector is deeply turned off with white LED Off.
(You can recover to Power ON only with Power Button.)

- Volume Ctrl (+ / -)

When you press Volumes Buttons, volume is increased(+) or decreased(-).

Network Connection

For using internet, you shall setup network connection by your network environment.

Select "Network and Internet" on your google setting menu.

Connect your network(Ethernet or WiFi AP(Access Point)).

Beam Output

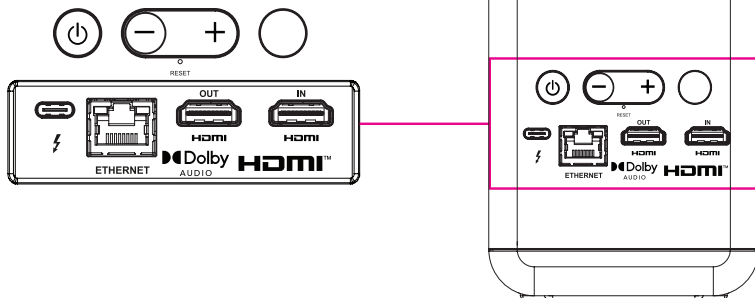

Case of connecting neither HDMI IN nor HDMI OUT, Screen and sound come out through the Beam Projector.

TV Output (HDMI OUT)

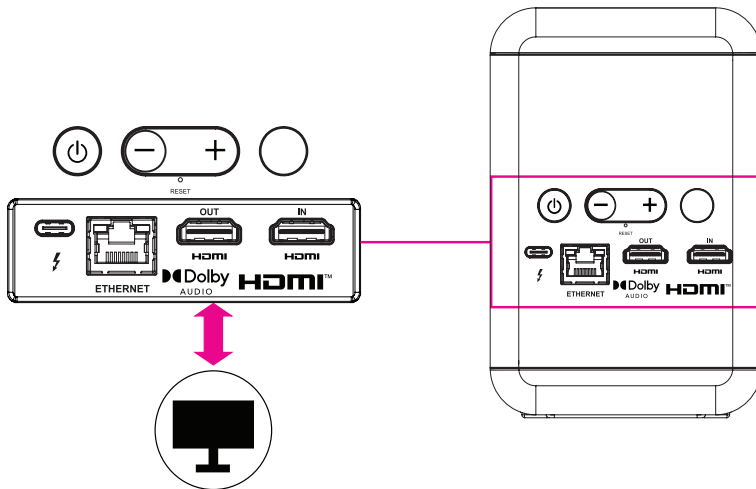

Case of connecting HDMI OUT, Screen and sound come out through your TV.

External Device Input (HDMI IN)

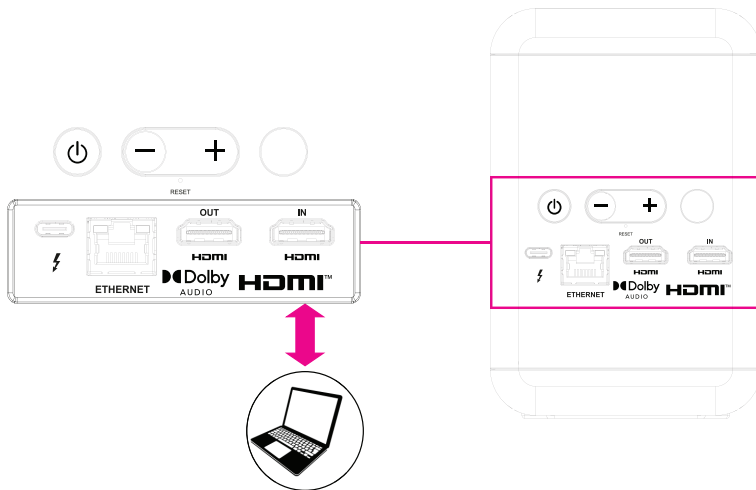

Case of connecting HDMI IN, External Device's Screen and sound come out through the Beam Projector.

Android Device Connection

You can project the screen from your Android devices.
Android devices shall support Google Chromecast.

On the Beam Projector :

Google Setting → Accounts and sign-in() → sign-in your account

On the Android device :

Select Chromecast() → Select your device

Entering Projector Setting Menu

You can setup Projector Setting Items.



(Droid Settings)

Select and Run DroidSettings App.



(Projector Settings)

Select "Projector Settings" item.

Controlling Projector Setting Items

You can setup Projector Setting Items on the “Projector Settings Menu”.

Droid Settings App() → Projector Settings()

Item	Description
Brightness	Control brightness (1 ~6)
Keystone Mode (Auto/Manual)	Auto (Automatic vertical compansation) Manual (Keep manual setting value)
Keystone Value	Manual Setting Range (-20 ~ 20)
Projection Mode	Front/Rear/InvertedFront/InvertedRear

*Reset

You can reset the Beamstar 3000 when it doe snot work properly.

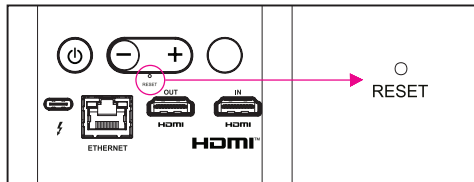

Connecting BT Remocon

You can connect and use BT Devices (including BT Remocon).

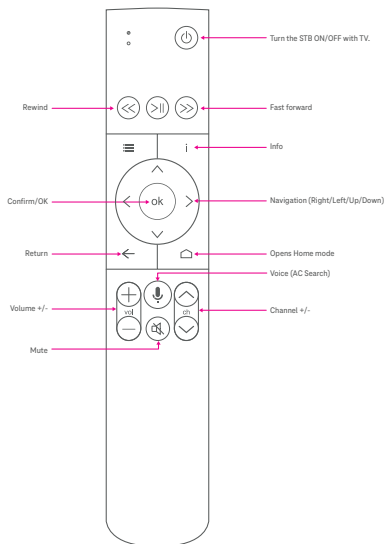

Software Upgrade (General)

You can use your projector stably by upgrading newest S/W.

Entering S/W Update Menu

Find and Select update menu with following steps.

Google Settings → Device Preferences → About → System updates

Scanning S/W Image

When running System updates, projector scans S/W Image.

If it is available, you can select “Download” and start updating.

Specifications

Specifications	
Light Source	R/G/B Laser
Display Panel	LCoS
Resolution	Full HD(1920x1080)
Brightness	500 Lumen
Focus	Focus-free
Main Processor	Amlogic S905X4
RAM	3GB
Internal Storage	16GB
OS	Android TV 12
Speaker	3W + 3W (Stereo)
Wi-Fi	802.11 a/b/t/n/ac(2.4/5.0 GHz)
Bluetooth	V5.0
HDMI	HDMI IN / HDMI OUT
Wireless Screen Mirroring	Chromecast Menu for Android Phone(Google Home) AirScreen App. for iPhone(Airplay)
USB	USB 3.0 Host
Battery Life time	2 hours (5,600mAh)
Dimensions	95 x 104 x 140 (mm)
Power	DC 15V/3A / Type C Adapter
Laser Safety Class	Class 1 Certificated

Cautions

We sincerely appreciate your purchase of our product. Please read all the safety information prior to using this product.



Warning

Violation of these instructions may result in fire, injury, or damage to the product or other property.

Do not stare into the beam

Use of controls or adjustments or performance of procedures other than those specified herein may result in hazardous radiation exposure.

This device complies with part 15 of the FCC Rules. Operation is subject to the following two

conditions: (1) This device may not cause harmful interference, and (2) this device must accept any interference received, including interference that may cause undesired operation.

Do not use this product while driving a car.

It may cause a dangerous situation like a traffic accident. This could be punishable by law.

Do not disassemble or modify.

Arbitrary installation, disassembling or modification may cause device failure, explosion, fire, electrocution. Manufacturer is not liable for such damages.

* Warning: You may be exposed to harmful radiation if you arbitrarily install, disassemble, or modify this product.

Do not submerge in water. Do not leave or use in excessively humid areas.

This product is not water-proofed. Exposure to water or excessive humidity could lead to fire or electrocution.

The packaging material included is not suitable for recreational use.

The plastic bags and metal parts included in the packaging material are not suitable for children or pets to use as toys.

Do not expose to excessive heat such as from a heater, microwave oven, or hair dryer.

This could cause warping, explosion or malfunctioning.

Avoid leaving or using this product in direct sunlight, excessively dusty area, possible water splashing area, excessively humid area, near heating appliance (Heater, microwave oven, etc.), or near flammable substance (Gasoline, painter thinner, flammable spray, etc.)

It may cause fire or electrocution as well as malfunctioning due to damage to product.

Do not insert metallic objects such as a hair pin, easily flammable paper, or a matchstick.

It may cause fire, electrocution, or malfunctioning due to damage to product.

Do not block the ventilation outlet while using the product with table cloth or curtain.

It may cause fire or explosion due to internal temperature rise.

This product is designed to work and to be stored in ambient temperatures between 10°C and 40°C.

This product can be damaged and battery life shortened if stored or operated outside of this temperature range. Please be extra careful since temperature inside a car may reach up to 80°C which may cause an explosion. When you are using this product or charging the battery, it is normal for the product to get warm.

Do not handle this product or plug with wet hands.

It may cause electrocution.

Do not look directly into the lens while the product is operating or do not aim it at anybody or pet.

Strong ray may cause damage your eyes.

Stop using this product in the event of smoke or unpleasant order. Turn off the power and unplug.

It may cause fire or electrocution.

In the event of a foreign object inserted into the product, turn off the power, unplug and call the service center. Foreign objects or water in the product may cause fire or electrocution.

Do not block the ray from lens with a book or other objects for long time.

Long exposure of ray to an object may cause fire due to high heat. Reflected heat may also damage the product.

Prevent the product from an impact or do not scratch with a sharp object.

It may cause damage to the product and malfunction.

Do not let children or pets lick the product.

Exterior material may cause allergic reactions as well as causing damage to the product.

Do not use this product while holding in hands or making body contact.

Heat from the beam projector may cause burn injuries. It is recommended to use at least 20 cm away from the product.

Recommended distance from the screen is 2 to 3 times of the diagonal length of the screen.

Viewing in close approximation for prolonged time may damage your eyes.

Do not use it for a prolonged period time.

Prolonged viewing could lead to damage to the eyes. It is recommended to take adequate rest from viewing at one hour intervals. If you experience eye sight difficulty or problems during viewing, stop viewing immediately.

Only use the charger and cables authorized and issued by the manufacturer.

Other products may not function properly or cause damage to the product or battery.

Make sure you check the voltage and type of the plug before use.

These may vary in different countries.

Do not twist or pull the cable forcefully, and do not change them too regularly or place heavy objects on them.

Failure to follow this guidance may lead to damage to the cable, malfunction, or electrocution.

Do not touch the lens directly with the hands, fingers or skin.

A dirty or smudged lens leads to lower image quality.

When cleaning the product, wipe slowly with a soft, dry cloth.

Ensure the charger is disconnected from the product and that the power is off. Do not use solvents, alcohol or thinner to wipe the product.

Caution: Potentially hazardous radiation emitted from this device.

Do not stare directly into the lens.

Read the following instructions carefully in order to handle the battery safely.

The battery takes approximately 4 hours to charge and has a standard operating time of approximately 2 hours.

*Charging time is measured with an authentic charge and cable.

*Battery usage and operating time is based on the battery in its initial state.

When the battery has no charge, the lamp does not light up even if the charger is connected. Charge for at least a few minutes before using.

Battery life diminishes gradually with repeated use. Once the battery life has diminished to half that of its original state, replace it with a new battery through the service center.

Installing the Product

Install the product on a flat, stable surface.

When using the product while connected to a charger, ensure use at an appropriate distance from the power outlet in order to avoid breaking the connection. Infliction of shock or impact to the charger or cable could lead to the product falling or damage to the terminal.

Please refrain from using in the following places:

Hospitals or near medical equipment that is affected by high wave frequencies

Near cardiac defibrillators or hearing aids

Near many electronic and/or wireless devices (kitchens, cars, aircraft cabins etc.)



Dolby and the double-D symbol are registered trademarks of Dolby Laboratories Licensing Corporation



The terms HDMI, HDMI High-Definition Multimedia Interface, HDMI Trade dress and the HDMI Logos are trademarks or registered trademarks of HDMI Licensing Administrator, Inc.